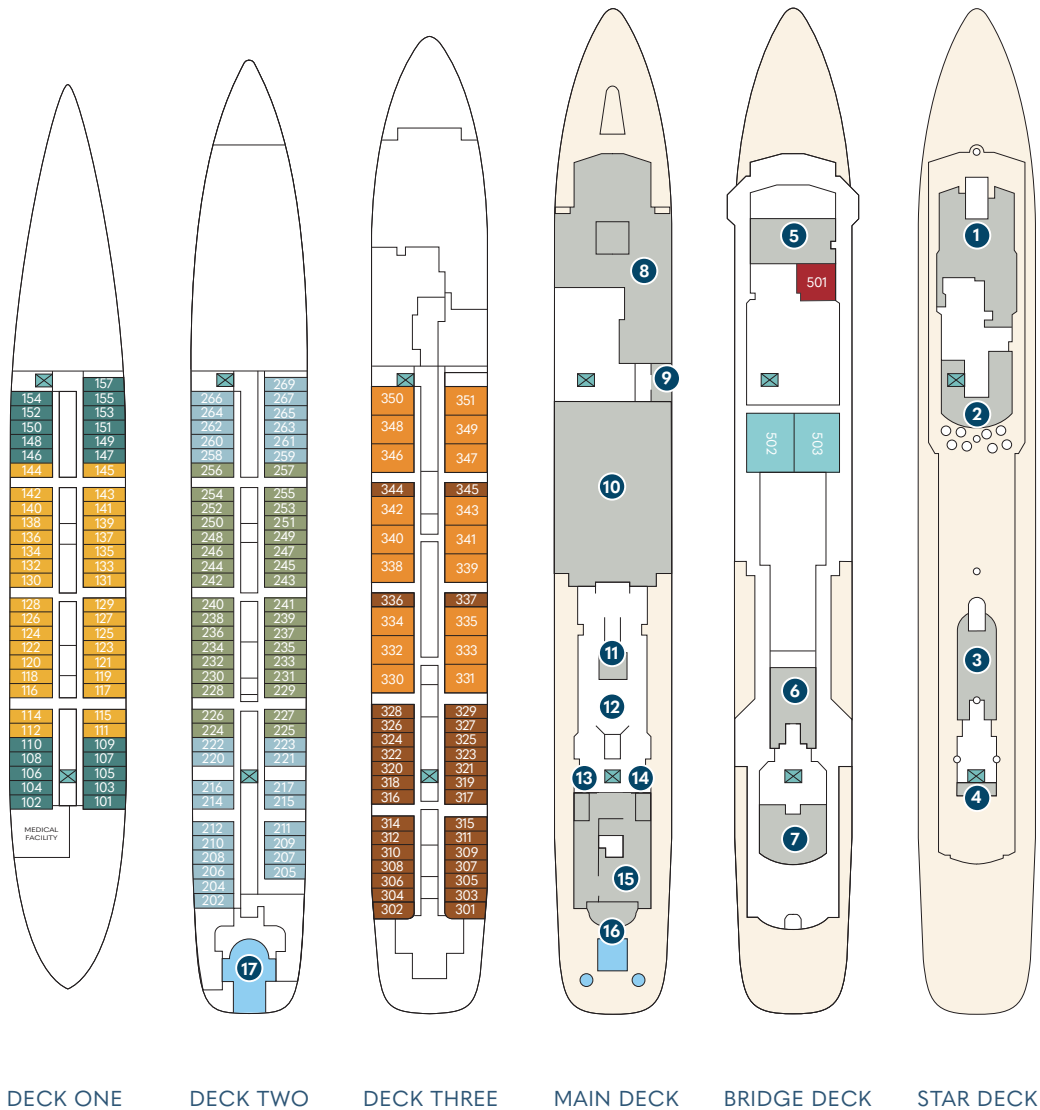

DIAGRAM KEY

- Broadmoor 502
Sea Island 503
- Owner's Suite
- Suites
- Category TX
- Category AX
- Category A
- Category BX
- Category B
- Public Spaces
- Stairs / Elevator



Wind SURF

FIVE-MASTED SAILING YACHT
(342 GUESTS)

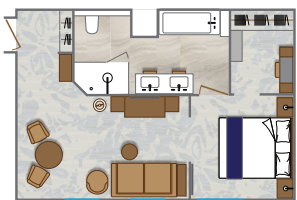

BROADMOOR &
SEA ISLAND SUITES

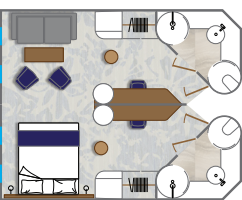

SUITE

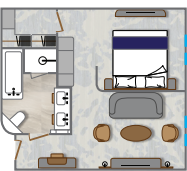

OWNERS' SUITE

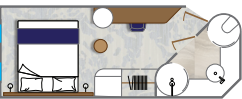

STATEROOM



Amphora Restaurant



Owners' Suite

ONBOARD SPACES:

- | | |
|-------------------------|---------------------------------|
| 1 Stella Bistro | 10 Lounge |
| 2 Veranda/Candles | 11 Reception |
| 3 Fitness Center | 12 Yacht Club Café |
| 4 Terrace Bar | 13 Cruise Consultant Desk |
| 5 Bridge | 14 Destination Desk |
| 6 World Spa by Windstar | 15 Star Boutique |
| 7 Compass Rose Bar | 16 Pool / Pool Bar / Whirlpools |
| 8 Amphora Restaurant | 17 Marina |
| 9 Amphora Wine Room | |



Wind Surf

Access to board ship is via stairs only.
Access to/from outside deck may require assistance with doors and thresholds.

STATEROOMS & SUITES

Broadmoor and Sea Island Suites:
495 square feet
(46 square meters)

Owner's Suite:
242 square feet
(22.5 square meters),
1 bathroom

Suites:
376 square feet
(35 square meters),
2 bathrooms

Staterooms:
188 square feet
(18 square meters)

Staterooms with 3rd Berths:
117-140; all suites

Staterooms with One Queen Size Bed Only (no twin option):
101, 102, 157, 202, 204,
269, 301-302, 303-304

WIND SURF undergoes a refresh in December 2024. The refresh brings the tight-knit connection of the Windstar community to the forefront through the redesign of public spaces and Broadmoor, Sea Island and Owner's Suites. From a revamped lobby to a new pool and larger pool bar, new World Spa by Windstar to a redesigned lounge, this initiative also includes intricate details like new teak decks and décor for a timeless and welcoming experience.

Illustrations are representative only. Actual layout of ships may vary slightly.

YACHT FACTS

GUEST CAPACITY:
342

GUEST DECKS:
6

CREW MEMBERS:
213

LENGTH:
535 feet (162 meters) at
waterline; 615 feet (188.8
meters) including bowsprit

DRAFT:
16 feet (5 meters)

TONNAGE:
14,745 gross registered
tons (grt)

BEAM:
66 feet (20 meters)

SAILS:
7 triangular, self-furling,
bridge-operated sails
with 26,881 square feet
(2,600 square meters)
of Dacron surface area

MASTS:
5 at 221 feet (67.5 meters)

MAIN ENGINES:
4 2430kw Wartsila Engines

SPEED:
10 to 12 knots with engines
only; up to 15 knots with
prevailing wind

SHIP'S REGISTRY:
Bahamas